

# Concord

From the Lo-Line starting at just 144mm high, to the Vertical at up to 2 metres and everything in between - the high efficiency Concord range is not only incredibly stylish but offers great flexibility with four radiator design options.



Choice of 4 different radiator options

- |   |                   |   |
|---|-------------------|---|
| 1 | Concord Plane:    | 102 models, 3 heights,<br>widths from 500mm to 3000mm |
| 2 | Concord Lo-Line:  | 16 models, 2 heights and 8 width options              |
| 3 | Concord Vertical: | 6 models, 2 heights and 3 width options               |
| 4 | Concord Slimline: | 8 models, 2 heights and 4 width options               |

Outputs: 382 to 6278 watts, 1304 to 21419 Btu/hr

## Concord temperature table

### TEMPERATURES

Factors for differences between mean water temperature and room temperature in °C and °F other than 50°C (90°F)

°C		°F	
5	0.050	10	0.057
10	0.123	20	0.142
15	0.209	30	0.240
20	0.304	40	0.348
25	0.406	50	0.466
30	0.515	60	0.590
35	0.629	70	0.721
40	0.748	80	0.858
45	0.872	90	1.000
50	1.000	100	1.147
55	1.132	110	1.298
60	1.267	120	1.454
65	1.406	130	1.613
70	1.549	140	1.776
75	1.694	-	-

To apply the factors shown in the table below to our quoted outputs, multiply the quoted output by the chosen operating factor to give new output.

To apply the factor to required output, divide required output by factor to give correct radiator from the Stelrad Concord range.

## General

The Stelrad Concord Plane and Lo-line radiators consist of flat oval precision tubes, pressure welded with a four mm air gap to symmetric water channels. The same precision tubes are used on the vertical and slimline models, however the creative use of the tubes to display the slim face on the slimline model offers additional visual appeal.

## Connections

2 x 15mm connections BOE are fitted as standard. 4 x 15mm connections are available as an optional extra, prices available on request.

## Testing and operating pressures

All models are high pressure tested to 6 bar with a maximum working pressure of 4.6 bar.

## Materials used

Flat oval steel tubes 70mm x 8mm. Water channel tubing 37mm x 32mm.

## Water Treatment

On completion of the installation, the system should be properly flushed and filled in accordance with the British Standard Code of Practice for the Treatment of Water in Domestic Hot Water Central Heating Systems BS 7593:2006.

This will remove flux residues and installation debris, which might promote corrosion and damage within the system.

If it is decided to apply a high performance corrosion inhibitor to maximise the working life of the system, it should be applied in accordance with the manufacturer's instructions and should be suitable for the particular metals within the system.

A comprehensive range of quality chemicals including inhibitors, cleaners, leak sealers and noise reducers that protect and maintain central heating systems can be obtained from:

Sentinel Performance Solutions Ltd  
The Heath Business & Technical Park, Runcorn,  
Cheshire WA7 4QX

Tel: 01928 588 330 (UK)

Fernox - Cookson Electronics,  
Forsyth Road, Sheerwater, Woking,  
Surrey GU21 5RZ

Tel: 01483 793200

## Colours

The Stelrad Concord range colour is standard in RAL 9016 pure white. All models are available in a choice of 34 RAL colours and 4 metallic colours to special order.

## Warranty

As a measure of the all round dependable quality and performance the Stelrad Concord range comes complete with a 5 year Manufacturer's Warranty.

For further information and advice call Technical Support on: 01482 498663.

## Concord feet fixing positions

All dimensions in mm. Inches in brackets. Feet must be specified at time of ordering as they are securely welded during manufacture.

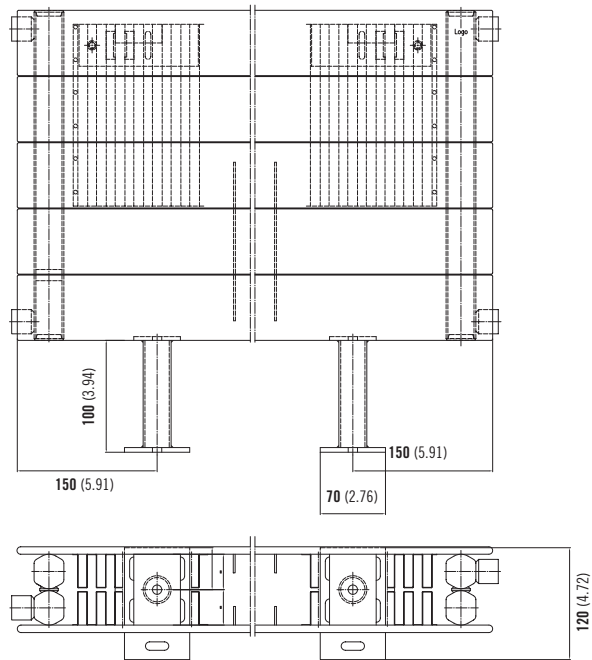

Floor mounting feet.



Optional extension pieces for easy replacement.



Optional 3/4 inch valve adaptor for connection without performance reduction.



The Stelrad STARS Heatloss Calculator contains an inbuilt U value calculator.

Save time and effort by using the Stelrad STARS program – the perfect solution for accurate sizing and design flexibility.

## Concord Slimline fixing positions

All dimensions in mm. Inches in brackets.

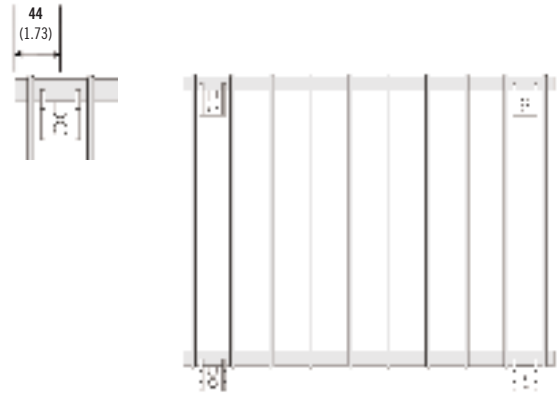

## Concord Plane Single, Concord Plane Double, Concord Lo-Line and Concord Vertical wall mounting information

All dimensions in mm. Inches in brackets.

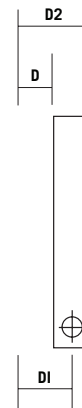
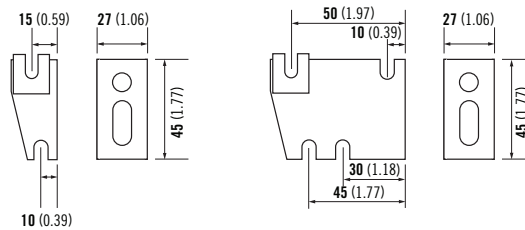

Type	From back of radiator to wall D		From wall to centre of connections D1		From front of radiator to wall D	
	mm	in	mm	in	mm	in
Plane Single	9	0.35	44	1.73	69	2.72
Plane Double	27	1.06	94	3.70	119	4.69
Vertical	25	0.98	44	1.73	70	2.76

## Concord Slimline wall mounting information

All dimensions in mm. Inches in brackets.

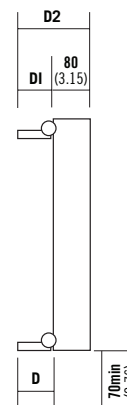
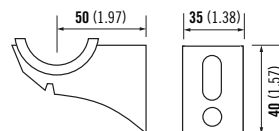

Type	Back face to finished wall D		Connection centres from finished wall D1		Front face from finished wall D2	
	mm	in	mm	in	mm	in
Slimline	35	1.38	50	1.97	130	5.12

## Concord Lo-Line fixing positions

All dimensions in mm. Inches in brackets.

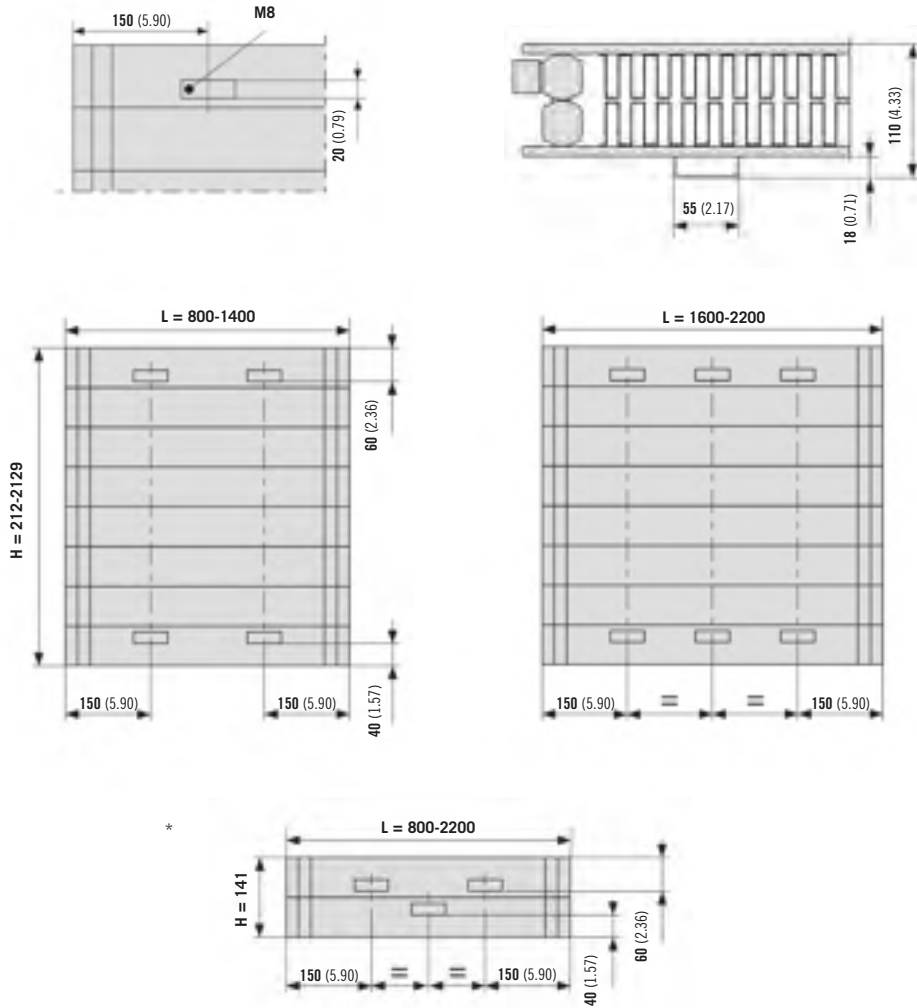

\*Welded-on foot supports recommended

## Concord Vertical fixing positions

All dimensions in mm. Inches in brackets.

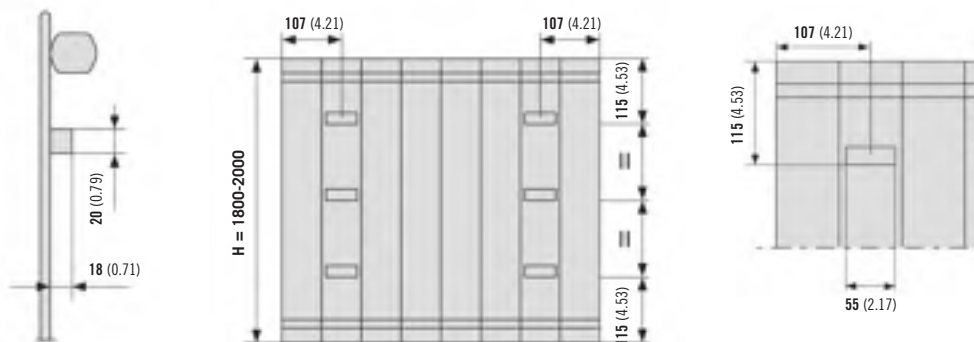

## Concord Plane Single fixing positions

All dimensions in mm. Inches in brackets.

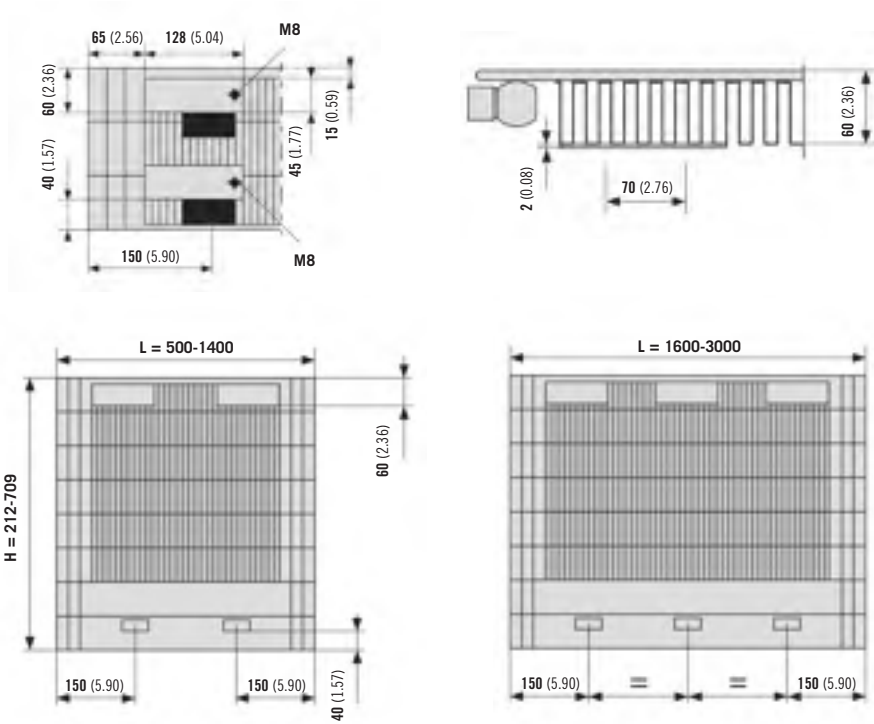

## Concord Plane Double fixing positions

All dimensions in mm. Inches in brackets.

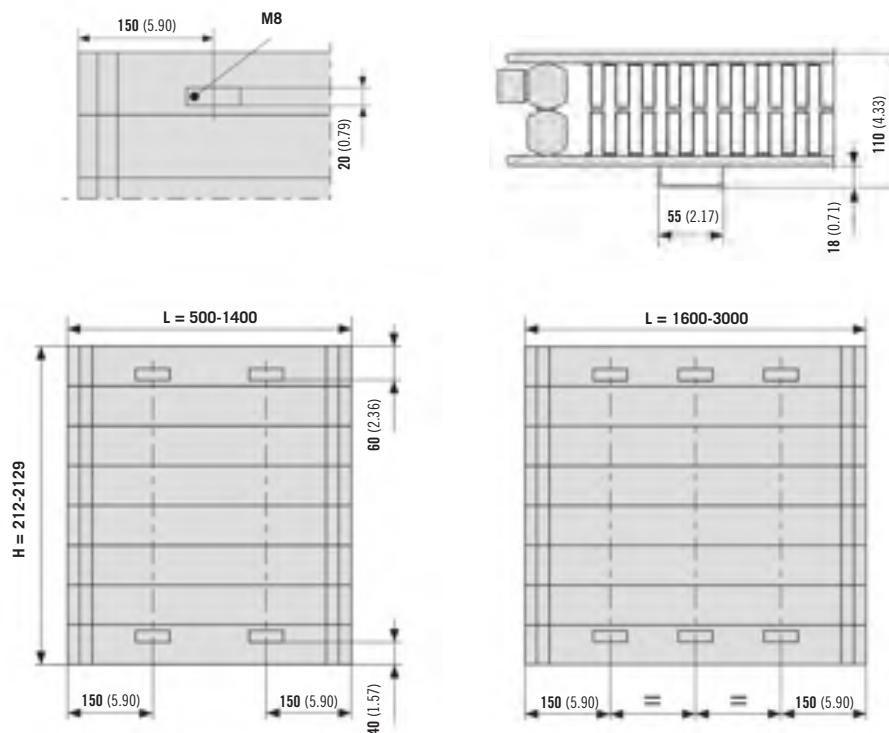

# Stelrad Concord

Vertical      **50**  $\Delta t$       **40**  $\Delta t$       **30**  $\Delta t$

Height	Length mm	Elements	Heat output		Heat output		Heat output	
			Watts	Btu/hr	Watts	Btu/hr	Watts	Btu/hr
1800	440	6	780	2661	583	1991	402	1371
	588	8	1040	3548	778	2654	536	1827
	736	10	1300	4436	972	3318	670	2284
2000	440	6	870	2968	651	2220	448	1529
	588	8	1160	3958	868	2961	597	2038
	736	10	1450	4947	1085	3701	747	2548

## Weights & Measures      Vertical

Height	Length		Tap centre mm	Dry weight Kg	Water content Litres	Surface area m <sup>2</sup> /m
	mm	in				
1800	440	17.3	440	19.86	4.26	NA
	588	23.1	588	26.48	5.68	NA
	736	28.9	736	33.10	7.10	NA
2000	440	17.3	440	21.90	4.68	NA
	588	23.1	588	29.20	6.24	NA
	736	28.9	736	36.50	7.80	NA

# Stelrad Concord

Slimline      **50**  $\Delta t$       **40**  $\Delta t$       **30**  $\Delta t$

Height	Length mm	Elements	Heat output		Heat output		Heat output	
			Watts	Btu/hr	Watts	Btu/hr	Watts	Btu/hr
1800	320	8	872	2975	652	2225	449	1532
	440	11	1199	4091	897	3060	617	2107
	520	13	1417	4835	1060	3616	730	2490
	640	16	1744	5951	1305	4451	898	3065
2000	320	8	978	3337	732	2496	504	1719
	440	11	1344	4586	1005	3430	692	2362
	520	13	1589	5422	1189	4055	818	2792
	640	16	1956	6674	1463	4992	1007	3437

## Weights & Measures      Slimline

Height	Length		Tap centre mm	Dry weight Kg	Water content Litres	Surface area m <sup>2</sup> /m
	mm	in				
1800	320	12.5	320	24.90	5.60	NA
	440	17.3	440	34.23	7.70	NA
	520	20.4	520	40.47	9.10	NA
	640	25.1	640	49.81	11.20	NA
2000	320	12.5	320	25.12	6.16	NA
	440	17.3	440	34.54	8.47	NA
	520	20.4	520	40.82	10.01	NA
	640	25.1	640	50.24	12.32	NA

# Stelrad Concord

## Weights & Measures

### Lo-Line



### Plane Single



### Plane Double

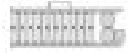

Height	Length		Tap centre mm	Dry weight Kg	Water content Litres	Surface area m <sup>2</sup> /m	Dry weight Kg	Water content Litres	Surface area m <sup>2</sup> /m	Dry weight Kg	Water content Litres	Surface area m <sup>2</sup> /m
	mm	in										
144	800	31.5	812	10.10	1.42	NA	-	-	-	-	-	-
	1000	39.4	1012	12.57	1.77	NA	-	-	-	-	-	-
	1200	47.2	1212	15.10	2.12	NA	-	-	-	-	-	-
	1400	55.1	1412	17.59	2.47	NA	-	-	-	-	-	-
	1600	63.0	1612	20.11	2.83	NA	-	-	-	-	-	-
	1800	70.9	1812	22.62	3.18	NA	-	-	-	-	-	-
	2000	78.7	2012	25.14	3.54	NA	-	-	-	-	-	-
	2200	86.6	2212	27.65	3.89	NA	-	-	-	-	-	-
292	800	31.5	812	20.04	2.86	NA	-	-	-	-	-	-
	1000	39.4	1012	25.05	3.57	NA	-	-	-	-	-	-
	1200	47.2	1212	30.06	4.28	NA	-	-	-	-	-	-
	1400	55.1	1412	35.07	4.99	NA	-	-	-	-	-	-
	1600	63.0	1612	40.08	5.71	NA	-	-	-	-	-	-
	1800	70.9	1812	45.09	6.42	NA	-	-	-	-	-	-
	2000	78.7	2012	50.10	7.14	NA	-	-	-	-	-	-
	2200	86.6	2212	55.11	7.85	NA	-	-	-	-	-	-
440	500	19.7	512	-	-	-	9.12	1.34	NA	16.40	2.66	NA
	600	23.6	612	-	-	-	10.93	1.60	NA	19.67	3.19	NA
	700	27.6	712	-	-	-	12.76	1.88	NA	22.95	3.72	NA
	800	31.5	812	-	-	-	14.58	2.14	NA	26.23	4.25	NA
	900	35.4	912	-	-	-	16.41	2.41	NA	29.51	4.78	NA
	1000	39.4	1012	-	-	-	18.23	2.68	NA	32.79	5.31	NA
	1100	43.3	1112	-	-	-	20.05	2.95	NA	36.07	5.84	NA
	1200	47.2	1212	-	-	-	21.88	3.22	NA	39.35	6.37	NA
	1400	55.1	1412	-	-	-	25.52	3.75	NA	45.91	7.43	NA
	1600	63.0	1612	-	-	-	29.17	4.29	NA	52.46	8.50	NA
	1800	70.9	1812	-	-	-	32.81	4.82	NA	59.02	9.56	NA
	2000	78.7	2012	-	-	-	36.46	5.36	NA	65.58	10.62	NA
	2200	86.6	2212	-	-	-	40.11	5.90	NA	72.14	11.68	NA
	2400	94.5	2412	-	-	-	43.75	6.42	NA	78.70	12.74	NA
	2600	102.4	2612	-	-	-	47.40	6.97	NA	85.25	13.81	NA
	2800	110.2	2812	-	-	-	51.04	7.50	NA	91.81	14.87	NA
3000	118.1	3012	-	-	-	54.96	8.04	NA	98.37	15.93	NA	
588	500	19.7	512	-	-	-	12.51	1.77	NA	22.51	3.55	NA
	600	23.6	612	-	-	-	15.00	2.12	NA	27.01	4.25	NA
	700	27.6	712	-	-	-	17.51	2.48	NA	31.51	4.96	NA
	800	31.5	812	-	-	-	20.00	2.83	NA	36.01	5.67	NA
	900	35.4	912	-	-	-	22.51	3.19	NA	40.51	6.38	NA
	1000	39.4	1012	-	-	-	25.01	3.54	NA	45.01	7.09	NA
	1100	43.3	1112	-	-	-	27.51	3.89	NA	49.51	7.80	NA
	1200	47.2	1212	-	-	-	30.01	4.25	NA	54.01	8.51	NA
	1400	55.1	1412	-	-	-	35.01	4.96	NA	63.01	9.93	NA
	1600	63.0	1612	-	-	-	40.02	5.66	NA	72.02	11.34	NA
	1800	70.9	1812	-	-	-	45.02	6.37	NA	81.02	12.76	NA
	2000	78.7	2012	-	-	-	50.02	7.08	NA	90.02	14.18	NA
	2200	86.6	2212	-	-	-	55.02	7.79	NA	99.02	15.60	NA
	2400	94.5	2412	-	-	-	60.02	8.50	NA	108.02	17.02	NA
	2600	102.4	2612	-	-	-	65.03	9.20	NA	117.03	18.43	NA
	2800	110.2	2812	-	-	-	70.03	9.91	NA	126.03	19.85	NA
3000	118.1	3012	-	-	-	75.03	10.62	NA	135.03	21.27	NA	
736	500	19.7	512	-	-	-	15.99	2.22	NA	28.72	4.43	NA
	600	23.6	612	-	-	-	19.19	2.66	NA	34.46	5.32	NA
	700	27.6	712	-	-	-	22.39	3.10	NA	40.21	6.20	NA
	800	31.5	812	-	-	-	25.58	3.54	NA	45.95	7.09	NA
	900	35.4	912	-	-	-	28.78	3.99	NA	51.70	7.97	NA
	1000	39.4	1012	-	-	-	31.98	4.43	NA	57.44	8.86	NA
	1100	43.3	1112	-	-	-	35.18	4.87	NA	63.18	9.75	NA
	1200	47.2	1212	-	-	-	38.38	5.32	NA	68.93	10.63	NA
	1400	55.1	1412	-	-	-	44.77	6.20	NA	80.42	12.40	NA
	1600	63.0	1612	-	-	-	51.17	7.09	NA	91.90	14.18	NA
	1800	70.9	1812	-	-	-	57.56	7.97	NA	103.39	15.95	NA
	2000	78.7	2012	-	-	-	63.96	8.86	NA	114.88	17.72	NA
	2200	86.6	2212	-	-	-	70.36	9.75	NA	126.37	19.49	NA
	2400	94.5	2412	-	-	-	76.75	10.63	NA	137.86	21.26	NA
	2600	102.4	2612	-	-	-	83.15	11.52	NA	149.34	23.04	NA
	2800	110.2	2812	-	-	-	89.54	12.40	NA	160.83	24.81	NA
3000	118.1	3012	-	-	-	95.94	13.29	NA	172.32	26.58	NA	

# Stelrad Concord

## 30 $\Delta$ t

**Lo-Line**



**Plane  
Single**



**Plane  
Double**

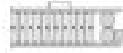

Height	Length mm	Elements	Heat output		Heat output		Heat output	
			Watts	Btu/hr	Watts	Btu/hr	Watts	Btu/hr
144	800	2	273	931	-	-	-	-
	1000	2	341	1165	-	-	-	-
	1200	2	410	1399	-	-	-	-
	1400	2	478	1631	-	-	-	-
	1600	2	546	1864	-	-	-	-
	1800	2	614	2096	-	-	-	-
	2000	2	683	2330	-	-	-	-
	2200	2	751	2564	-	-	-	-
292	800	4	462	1578	-	-	-	-
	1000	4	578	1972	-	-	-	-
	1200	4	693	2365	-	-	-	-
	1400	4	809	2761	-	-	-	-
	1600	4	924	3154	-	-	-	-
	1800	4	1040	3550	-	-	-	-
	2000	4	1156	3943	-	-	-	-
	2200	4	1271	4337	-	-	-	-
440	500	6	-	-	197	671	347	1183
	600	6	-	-	236	805	416	1420
	700	6	-	-	276	940	485	1655
	800	6	-	-	315	1074	555	1892
	900	6	-	-	354	1209	624	2128
	1000	6	-	-	393	1342	693	2365
	1100	6	-	-	433	1476	763	2602
	1200	6	-	-	472	1611	832	2838
	1400	6	-	-	551	1880	970	3311
	1600	6	-	-	629	2147	1109	3785
	1800	6	-	-	708	2416	1248	4258
	2000	6	-	-	787	2685	1386	4730
	2200	6	-	-	866	2954	1525	5203
	2400	6	-	-	945	3223	1663	5676
	2600	6	-	-	1023	3490	1803	6150
	2800	6	-	-	1102	3759	1941	6623
3000	6	-	-	1180	4027	2080	7095	
588	500	8	-	-	258	879	426	1453
	600	8	-	-	308	1053	511	1743
	700	8	-	-	360	1228	596	2035
	800	8	-	-	411	1404	681	2325
	900	8	-	-	463	1580	767	2616
	1000	8	-	-	514	1755	852	2906
	1100	8	-	-	566	1931	937	3196
	1200	8	-	-	617	2107	1022	3488
	1400	8	-	-	720	2458	1193	4070
	1600	8	-	-	823	2808	1363	4649
	1800	8	-	-	926	3159	1533	5231
	2000	8	-	-	1029	3511	1704	5813
	2200	8	-	-	1132	3862	1874	6394
	2400	8	-	-	1235	4214	2045	6976
	2600	8	-	-	1337	4563	2215	7556
	2800	8	-	-	1440	4915	2385	8138
3000	8	-	-	1543	5266	2555	8719	
736	500	10	-	-	312	1065	539	1838
	600	10	-	-	374	1277	646	2205
	700	10	-	-	437	1490	754	2573
	800	10	-	-	500	1704	862	2942
	900	10	-	-	562	1917	970	3309
	1000	10	-	-	624	2130	1077	3676
	1100	10	-	-	686	2342	1185	4043
	1200	10	-	-	749	2555	1293	4411
	1400	10	-	-	874	2982	1508	5147
	1600	10	-	-	999	3407	1724	5881
	1800	10	-	-	1124	3834	1939	6618
	2000	10	-	-	1248	4259	2155	7352
	2200	10	-	-	1373	4685	2370	8087
	2400	10	-	-	1498	5112	2586	8823
	2600	10	-	-	1623	5537	2801	9557
	2800	10	-	-	1748	5964	3017	10294
3000	10	-	-	1873	6389	3232	11028	

# Stelrad Concord

## 40<sub>Δt</sub>

Lo-Line



Plane  
Single



Plane  
Double

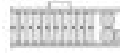

Height	Length mm	Elements	Heat output		Heat output		Heat output		
			Watts	Btu/hr	Watts	Btu/hr	Watts	Btu/hr	
144	800	2	396	1353	-	-	-	-	
	1000	2	496	1692	-	-	-	-	
	1200	2	595	2032	-	-	-	-	
	1400	2	694	2368	-	-	-	-	
	1600	2	794	2708	-	-	-	-	
	1800	2	892	3045	-	-	-	-	
	2000	2	992	3384	-	-	-	-	
	2200	2	1091	3724	-	-	-	-	
	292	800	4	672	2292	-	-	-	-
		1000	4	839	2864	-	-	-	-
1200		4	1007	3435	-	-	-	-	
1400		4	1175	4009	-	-	-	-	
1600		4	1343	4581	-	-	-	-	
1800		4	1511	5155	-	-	-	-	
2000		4	1679	5727	-	-	-	-	
2200		4	1846	6299	-	-	-	-	
440		500	6	-	-	286	975	503	1718
		600	6	-	-	343	1169	604	2062
	700	6	-	-	400	1365	705	2404	
	800	6	-	-	457	1559	806	2749	
	900	6	-	-	515	1756	906	3091	
	1000	6	-	-	571	1950	1007	3435	
	1100	6	-	-	628	2144	1108	3780	
	1200	6	-	-	686	2340	1208	4122	
	1400	6	-	-	800	2731	1409	4808	
	1600	6	-	-	914	3119	1611	5497	
	1800	6	-	-	1029	3510	1812	6184	
	2000	6	-	-	1143	3900	2014	6870	
	2200	6	-	-	1257	4290	2215	7557	
	2400	6	-	-	1372	4681	2416	8244	
	2600	6	-	-	1486	5069	2618	8933	
	2800	6	-	-	1600	5459	2819	9619	
	3000	6	-	-	1714	5850	3020	10306	
	588	500	8	-	-	374	1276	619	2111
600		8	-	-	448	1529	742	2532	
700		8	-	-	523	1784	866	2955	
800		8	-	-	598	2039	990	3377	
900		8	-	-	672	2294	1114	3800	
1000		8	-	-	747	2550	1237	4221	
1100		8	-	-	822	2805	1361	4642	
1200		8	-	-	897	3060	1485	5066	
1400		8	-	-	1046	3570	1732	5911	
1600		8	-	-	1195	4078	1979	6753	
1800		8	-	-	1345	4589	2227	7598	
2000		8	-	-	1495	5099	2474	8443	
2200		8	-	-	1644	5610	2722	9287	
2400		8	-	-	1794	6120	2970	10132	
2600		8	-	-	1943	6628	3216	10974	
2800		8	-	-	2092	7138	3464	11819	
3000		8	-	-	2242	7649	3712	12664	
736		500	10	-	-	453	1547	782	2670
	600	10	-	-	544	1855	939	3203	
	700	10	-	-	634	2164	1095	3736	
	800	10	-	-	726	2476	1252	4272	
	900	10	-	-	816	2784	1408	4806	
	1000	10	-	-	907	3093	1565	5339	
	1100	10	-	-	997	3402	1721	5873	
	1200	10	-	-	1088	3711	1877	6406	
	1400	10	-	-	1269	4331	2191	7475	
	1600	10	-	-	1450	4949	2504	8542	
	1800	10	-	-	1632	5569	2817	9611	
	2000	10	-	-	1813	6186	3130	10678	
	2200	10	-	-	1994	6804	3442	11745	
	2400	10	-	-	2176	7424	3756	12814	
	2600	10	-	-	2357	8042	4068	13881	
	2800	10	-	-	2539	8662	4382	14951	
	3000	10	-	-	2720	9280	4694	16017	

# Stelrad Concord

50  $\Delta t$

Lo-Line



Plane  
Single



Plane  
Double

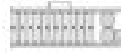

Height	Length mm	Elements	Heat output		Heat output		Heat output		
			Watts	Btu/hr	Watts	Btu/hr	Watts	Btu/hr	
144	800	2	530	1809	-	-	-	-	
	1000	2	663	2263	-	-	-	-	
	1200	2	796	2717	-	-	-	-	
	1400	2	928	3167	-	-	-	-	
	1600	2	1061	3621	-	-	-	-	
	1800	2	1193	4071	-	-	-	-	
	2000	2	1326	4525	-	-	-	-	
	2200	2	1459	4979	-	-	-	-	
	292	800	4	898	3065	-	-	-	-
		1000	4	1122	3829	-	-	-	-
1200		4	1346	4594	-	-	-	-	
1400		4	1571	5362	-	-	-	-	
1600		4	1795	6126	-	-	-	-	
1800		4	2020	6894	-	-	-	-	
2000		4	2244	7658	-	-	-	-	
2200		4	2468	8423	-	-	-	-	
440		500	6	-	-	382	1303	673	2296
		600	6	-	-	458	1563	808	2757
	700	6	-	-	535	1826	942	3214	
	800	6	-	-	611	2085	1077	3675	
	900	6	-	-	688	2348	1211	4132	
	1000	6	-	-	764	2607	1346	4593	
	1100	6	-	-	840	2867	1481	5053	
	1200	6	-	-	917	3130	1615	5512	
	1400	6	-	-	1070	3651	1884	6430	
	1600	6	-	-	1222	4170	2154	7351	
	1800	6	-	-	1375	4692	2423	8267	
	2000	6	-	-	1528	5215	2692	9187	
	2200	6	-	-	1681	5736	2961	10104	
	2400	6	-	-	1834	6258	3230	11023	
	2600	6	-	-	1986	6778	3500	11945	
	2800	6	-	-	2139	7298	3769	12863	
	3000	6	-	-	2292	7822	4038	13781	
	588	500	8	-	-	500	1706	827	2822
600		8	-	-	599	2044	992	3385	
700		8	-	-	699	2385	1158	3951	
800		8	-	-	799	2726	1323	4514	
900		8	-	-	899	3067	1489	5082	
1000		8	-	-	999	3409	1654	5643	
1100		8	-	-	1099	3750	1819	6206	
1200		8	-	-	1199	4091	1985	6773	
1400		8	-	-	1399	4775	2316	7902	
1600		8	-	-	1598	5454	2646	9028	
1800		8	-	-	1798	6135	2977	10158	
2000		8	-	-	1998	6819	3308	11287	
2200		8	-	-	2198	7500	3639	12416	
2400		8	-	-	2398	8182	3970	13549	
2600		8	-	-	2597	8863	4300	14672	
2800		8	-	-	2797	9546	4631	15801	
3000		8	-	-	2997	10226	4962	16934	
736		500	10	-	-	606	2068	1046	3569
	600	10	-	-	727	2481	1255	4282	
	700	10	-	-	848	2893	1464	4995	
	800	10	-	-	970	3310	1674	5712	
	900	10	-	-	1091	3722	1883	6425	
	1000	10	-	-	1212	4135	2092	7138	
	1100	10	-	-	1333	4548	2301	7851	
	1200	10	-	-	1454	4961	2510	8564	
	1400	10	-	-	1697	5792	2929	9994	
	1600	10	-	-	1939	6616	3347	11420	
	1800	10	-	-	2182	7447	3766	12850	
	2000	10	-	-	2424	8275	4184	14276	
	2200	10	-	-	2666	9099	4602	15702	
	2400	10	-	-	2909	9928	5021	17132	
	2600	10	-	-	3151	10754	5439	18558	
	2800	10	-	-	3394	11583	5858	19987	
	3000	10	-	-	3636	12409	6276	21419	

# Concord

Offering visual appeal combined with advanced technology, the Concord range of radiators provides a contemporary solution to a wide range of building applications. With a choice of four different types of radiator and a variety of sizes and outputs, Concord allows extensive flexibility of siting whilst breaking new barriers in heating efficiency.

## Concord Plane

Constructed from slim flat tubes that lie horizontally, the Concord Plane offers a new vision for radiators. Available in 3 different heights with widths from 500mm to 3000mm, 102 models with outputs from 1304 Btu/hr 382 watts to 21,419 Btu/hr 6276 watts.

## Concord Lo-Line

With only two panels this Lo-line model is a derivative of the standard, but offers efficiency of performance that belies its size. 16 models with 2 height and 8 width options and outputs from 1809 Btu/hr 530 watts to 8423 Btu/hr 2468 watts.

## Concord Vertical

This resourceful alternative takes the same highly engineered tubes and turns technology on its head to provide a vertical model. 6 models with 2 height and 3 width options and outputs from 2662 Btu/hr 780 watts to 4949 Btu/hr 1450 watts.

## Concord Slimline

With all the benefits of the vertical model, the Concord Slimline offers a subtle visual appeal by displaying the slim form of the tubes. 8 models with 2 height and 4 width options and outputs from 2976 Btu/hr 872 watts to 6675 Btu/hr 1956 watts.

Whatever your building specification, you can be sure that this advanced range of radiators will provide elegant visual style, combined with top quality engineering and performance.

## Colours

RAL 7035		RAL 1004		RAL 6020		RAL 1013	
RAL 7038		RAL 2008		RAL 6012		RAL 1015	
RAL 7036		RAL 3017		RAL 6005		RAL 9002	
RAL 7030		RAL 3000		RAL 5014			
RAL 7037		RAL 3003		RAL 5022			
RAL 7015		RAL 3005		RAL 5024		<b>Metallics</b>	
RAL 9005		RAL 6027		RAL 5002		BR 0002	
RAL 8017		RAL 6034		RAL 5010		BR 0004	
RAL 1016		RAL 6019		RAL 9016		BR 0006	
RAL 1021		RAL 6033		RAL 9001		BR 0007	

The colours shown above are reproduced as accurately as this printing process will allow and are available to special order only on the these models. Specials are subject to a 50% restock fee if returned.



1



3



2

